

INSTALLATION MANUAL

B9025



LED
BUILT IN



UGR19

90
CRI



230V | SMD 2835 | 40W → 60W | IP20 | Diffuser | Aluminium

A SURFACE INSTALLATION

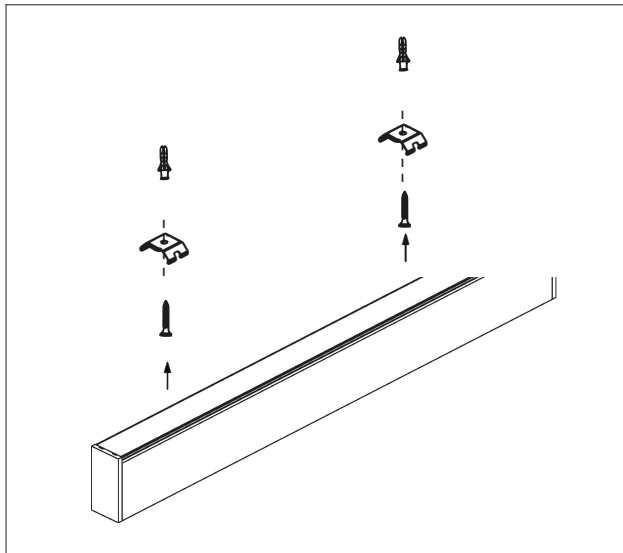

B SUSPENDED INSTALLATION

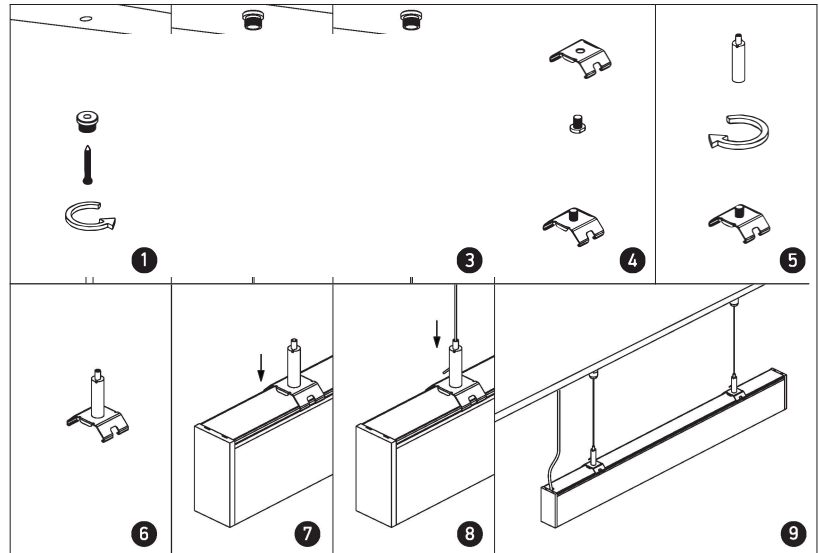

C CONNECTION

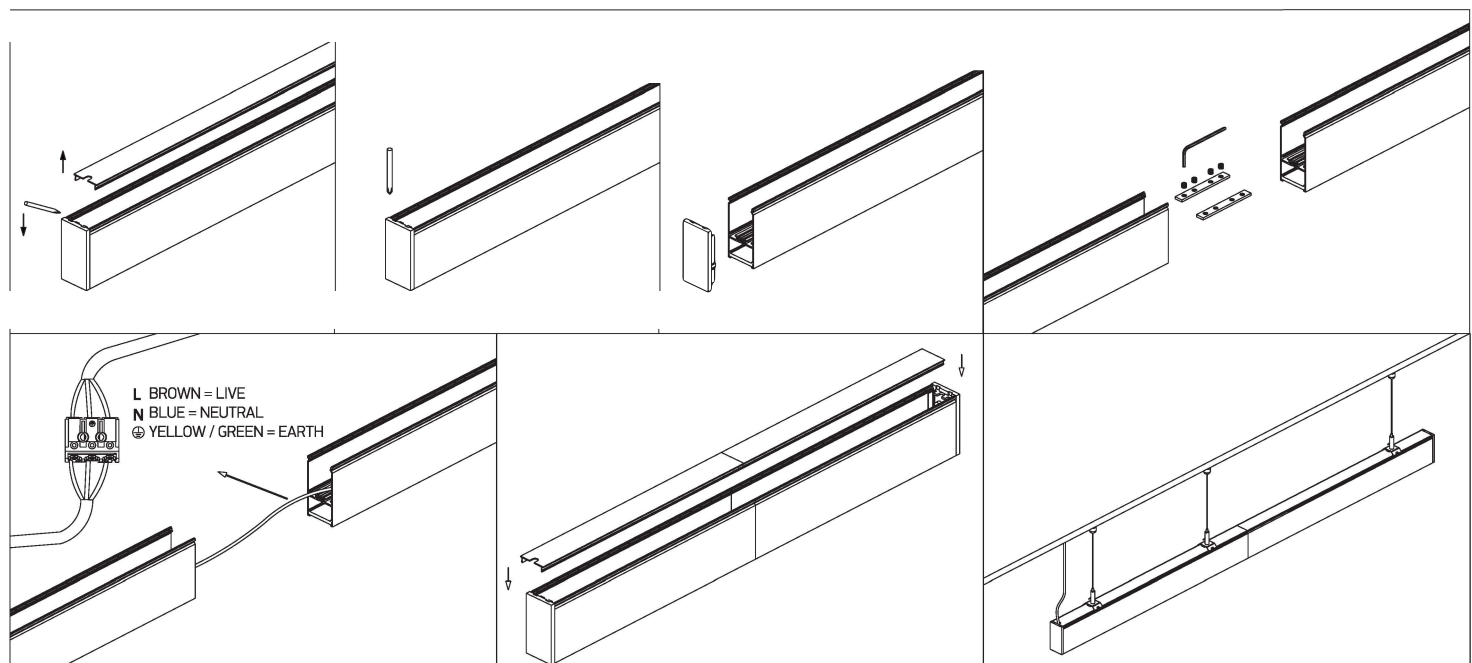

Warnings:

1. Make sure that the product is installed properly before connecting to electricity.
2. Do not cover the fitting.
3. Maintenance and installation should only be carried out by a professional electrician.