

Product Specification

Product name:Solar Lawn Light

Product Series: Exocet

Model No: ZQ-FY-***



Product Structure

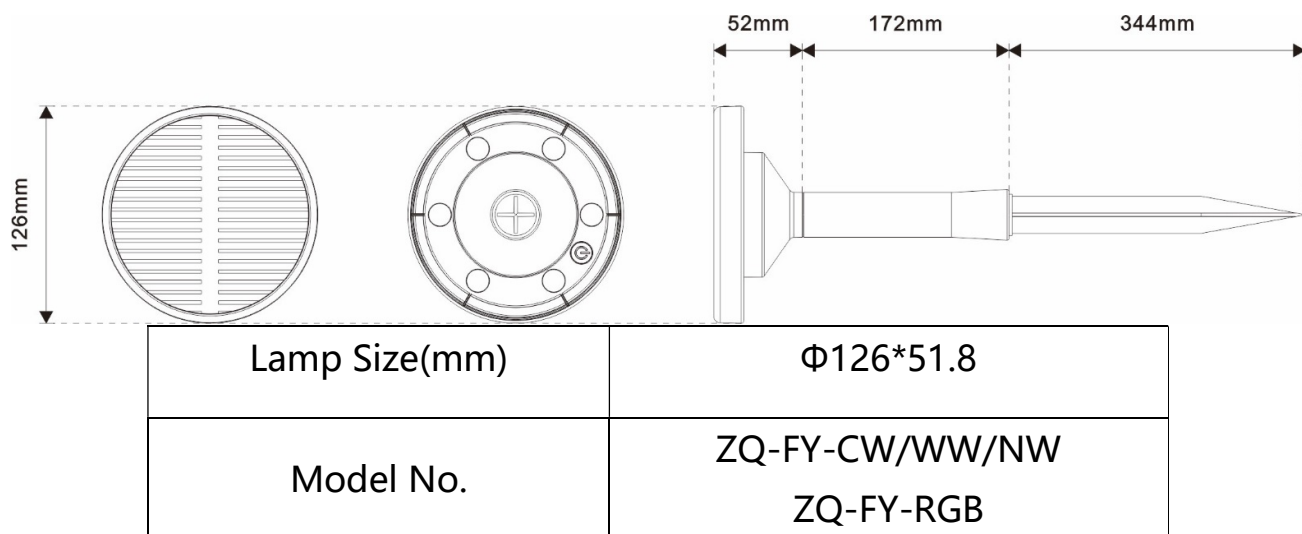

Packing

Inner box 130*56*205/2pcs, carton 465*275*540 64pcs/ctn

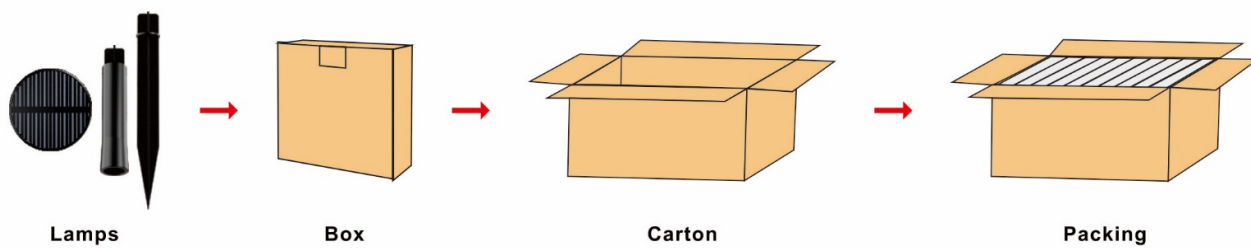

Product Composition

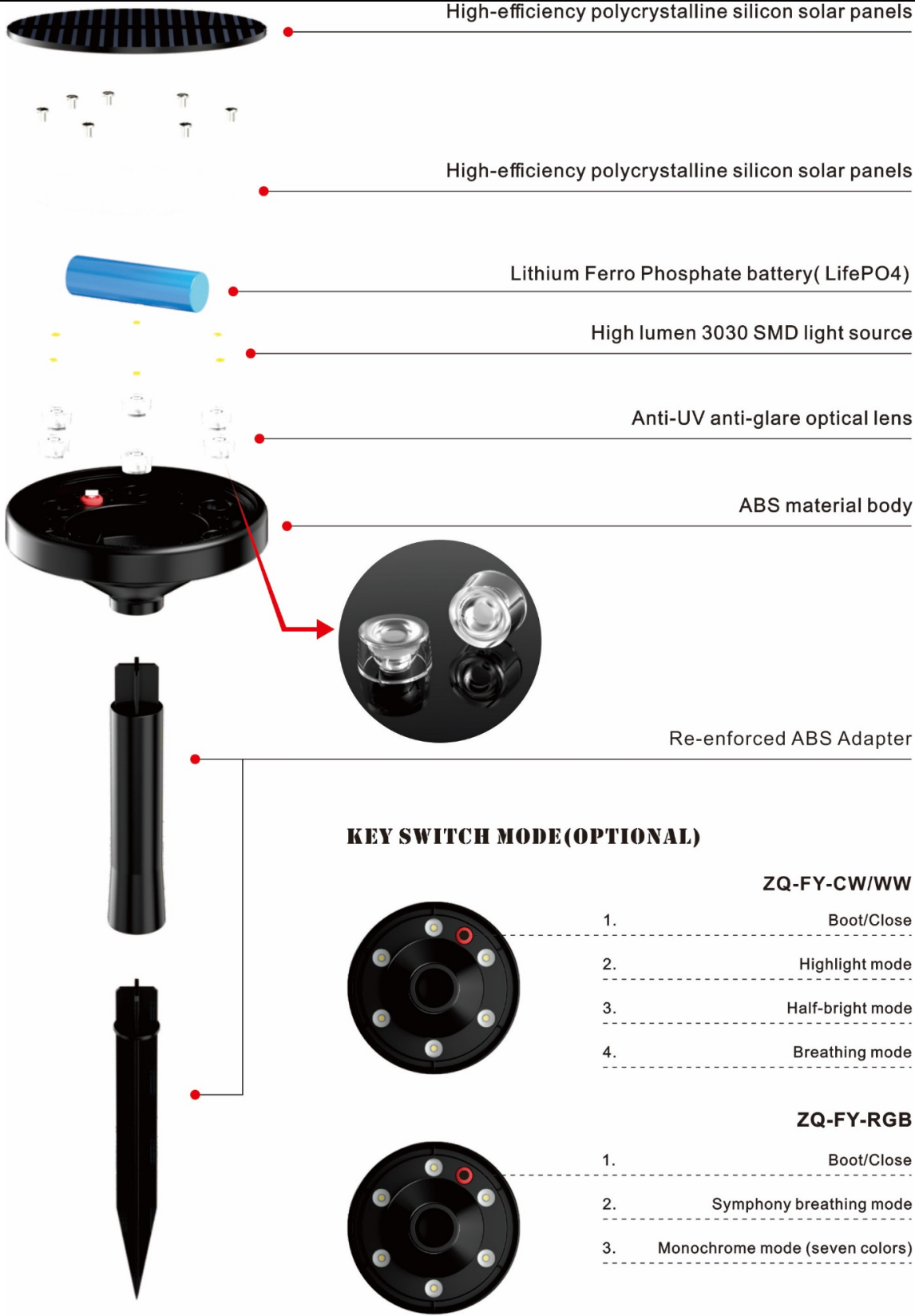

Product parameter

Item	Product parameter	
	ZQ-FY-CW/WW/NW	ZQ-FY-RGB
LED light source	SMD3030 6PCS 3000K/6500K/4000K (CCT)	SMD3030 6PCS RGB
Mode/workin g hours	Highlight mode>6H	Symphony breathing mode>12H
	Half light mode >12H	Monochrome mode (seven colors) >12H (button switch)
	Breathe mode>6H	Turn off
	Turn off	/
Solar panels	Polysilicon5.0V/1.1W, Φ115*2mm	
Battery	18650, 3.2V, 1200mAH	
Protective function	High voltage 3.7V, low voltage 2.1V	
Light control	Turn off the lights during the day to charge, turn on the lights to discharge at night	
Charging time	4-6 hours of normal light (>40000lux)	
Product size	Φ125*mm	
Material color	ABS black+PC	
IP Grade	IP65	

Product Control Mode

Touch the switch to control the induction mode, switch in a loop, after the mode has been selected, there is no need to switch again

ZQ-FY-CW/WW/NW:

- 1)、 Press the button to enter the highlight mode: when the button is pressed, the lamp body is on for 2S, and then the light control conditions are detected.
- 2)、 Press again to enter the semi-bright mode: when the button is pressed, the lamp body will be on for 2S, and then the light control conditions will be detected.
- 3)、 Press again to enter the breathing mode: when the button is pressed, the light body is on for 2S, and then the light control conditions are detected, the light is automatically turned on when it is dark, and the light is turned off during the day to charge
- 4)、 Press again to enter the off mode: the light can be charged but the light does not turn on in the dark

Touch the switch to control the mode, cycle switching, after the mode has been selected, there is no need to switch again

ZQ-FY-RGB:

- 1)、 Press the button to enter the magic color breathing mode: when the button is pressed, the light body will be on for 2S, and then the light control conditions will be detected.
 - 2)、 Press again to enter the monochrome mode (press once to switch one color, a total of seven colors): when the button is pressed, the light body will light up for 2S, and then the light control conditions will be detected.
 - 3)、 Press again to enter the off mode: the light can be charged but the light does not turn on when it is dark
-

Products Instructions

- 1) 、 This product is solar photovoltaic lighting, green environmental protection, low voltage safety
 - 2)、 Widely used in courtyards, lawns, gardens and other places
 - 3)、 Please place the lamp directly in the sun to charge for at least 6 hours before use
 - 4)、 Automatically charge during the day, automatically start and light up at night
 - 5)、 Easy to install, no wiring, no power connection and complicated installation process
 - 6) 、 When installing, please install the lamp in a place with strong sunlight and pay attention to the installation angle to ensure that the solar photovoltaic panel has enough sunlight to charge the battery
 - 7)、 The charging effect of solar photovoltaic panels depends on sunlight exposure, lighting time and weather conditions. The stronger the sunshine, the faster the solar photovoltaic panels are charged. In rainy or cloudy days, the charging effect will be weakened, and the lighting time will be shortened
 - 8)、 Internal charging overvoltage protection and low voltage discharge protection, safety circuit, stable quality
 - 9)、 Creative shape, independent research and development and production, patent private model
-

Installation Instructions

- 1)、 Insert the ground plastic tube into the bracket tube
- 2)、 insert the lamp to the position that needs to be illuminated
- 3)、 Press the switch to select the gear

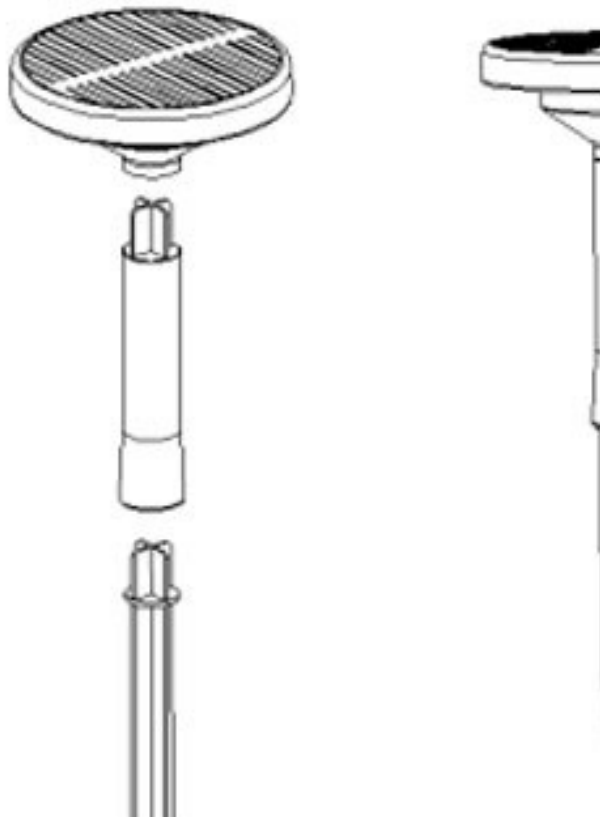

Important Notice

- ★Please keep the installation tools away from children
 - ★ Contains batteries, batteries are recyclable, please do not throw them away★ Contains batteries, the product is strictly prohibited to be placed on fire, it may explode
 - ★ Please do not connect to 110/220V alternating current to avoid damage to the lamp body
 - ★ Please install on a flat and stable surface, and fix the photovoltaic panel and the lamp body to prevent wind or other reasons from hurting people
 - ★In order not to affect the use effect, clean up the dust or debris on the surface of the solar photovoltaic panel every 3-4 months
 - ★ In autumn, winter, continuous cloudy or rainy days, the charging effect will be weakened and the lighting time will be shortened, which is normal
 - ★ Avoid installing lamps near air conditioners, heating objects, or high-voltage power grid systems
-