

10mm

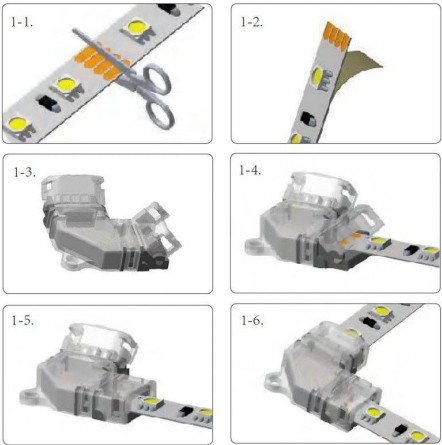

"L" corner connector for single color COB LED strip 12V/24V - 2 pins - 10mm strip

Ref. G-L-2P-10

L-connector for 12V and 24V single-color COB LED strips. Enables the quick and easy connection of sections of COB LED strips at a 90° angle without the need for tools. It has 2 pins and is suitable for strips with a total width of 10 mm. Due to its IP20 protection rating, this connector is suitable for indoor use.



Datos del producto

Nominal Voltage (V)	12-24V
Material	Polycarbonate
Use Outdoor	No
IP	IP20
Temperature range	-20°C ~ +40°C
Frequency of use	Intensive
Certificates	CE, ROHS
Warranty	According to legal guarantee: 2 years
Track width (mm)	10

