

10mm

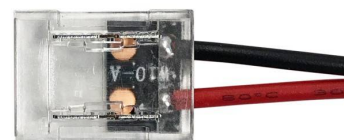
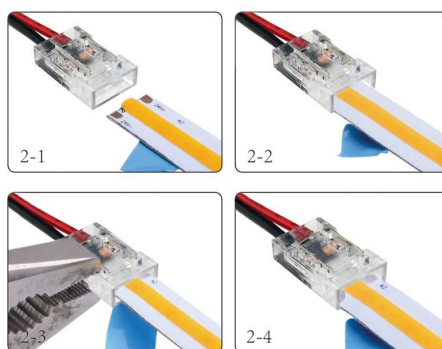

Connector for starting 10mm single color LED strips

Ref. G-A2P-10

Starter connector for 10mm single-color LED strips. It connects single-color LED strips directly to the power supply or to the corresponding controller. With the connector you can use the cut sections of the single-color LED strips, without soldering, allowing a custom installation. Suitable for both COB and SMD LED strips of 10mm width. IP20 degree of protection, for indoor use only. Strip to power connector. Wide voltage of 0/36V-DC. Maximum intensity 5A. With Black-Red central cable and a length of 150mm. 2 Pin. 10mm.

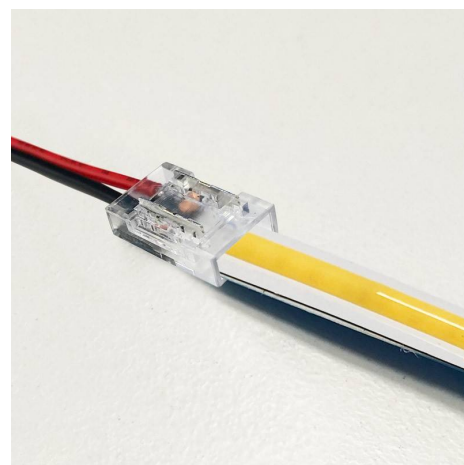

Datos del producto

Nominal Voltage (V)	0-36V-DC
Dimensions (mm) LxIxh	15.6x9.6x3.3x3.3
Material	Polycarbonate
Use Outdoor	No
IP	IP20
Temperature range	-20°C ~ +40°C
Frequency of use	Intensive
Certificates	CE, ROHS
Warranty	According to legal guarantee: 2 years
Track width (mm)	10
Control system	Monocolor
Maximum intensity (A)	5

