

8mm



Connector for strip to strip COB CLIP INVISIBLE 2 pin 8mm IP20

Ref. G-B2P-8

Connector between COB LED strips, to connect two high density LED strips. With a totally invisible structure, 2 Pin, suitable for COB strips with homogeneous light, avoiding dark areas. For 8mm wide IP20 LED strips. Connects strips without soldering. For indoor use only, with IP20 protection degree. Dimensions of 10x16x3mm and an intensity of 5A. Admitted voltage 0-36V.

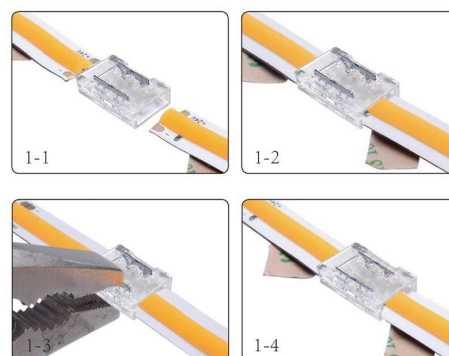

Datos del producto

Nominal Voltage (V)	0-36V-DC
Dimensions (mm) LxIxh	10x16x3
Material	ABS
Use Outdoor	No
IP	IP20
Temperature range	-20°C ~ +40°C
Certificates	CE, ROHS
Warranty	According to legal guarantee: 2 years
Track width (mm)	8

