

160° square PIR wall-mounted motion sensor

Ref. S3136

160°infrared sensor, with detection up to 8 meters, for devices or accumulation of loads up to 500W. For LED lights up to 200W. Easy lighting automation sensor switch. Works in three-wire installations and can turn on and off all types of lights. Mini Sensor ideal for replacing recessed switches and automate lights in hallways, stairs or bathrooms almost instantly, exclusively for indoor use with IP20 degree of protection. It works in installations with 3 wires. Thanks to the integrated button, a manual changeover is possible at any time.

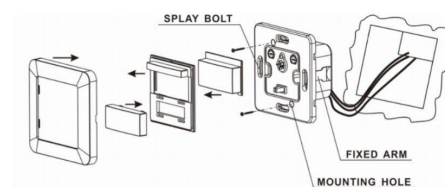

Datos del producto

Frequency (Hz)	50
Detection range (m)	8
Orientable	No
Dimensions (mm) LxIxh	80x80x49
Material	Plastic
Use Outdoor	No
IP	IP20
Temperature range	-20°C ~ +40°C
Frequency of use	Intensive
Energy efficiency class	A+ (2021)
Certificates	CE, ROHS
Warranty	According to legal guarantee: 2 years
Mounting	Surface
Maximum power (W)	200
Connectivity	PIR

