

LED water proof light

Installation and Operation Manual

Please read the following instructions carefully to ensure that mounting operation will be carried out in the right way. These instructions should be properly preserved for future reference.

Specifications

Model no	B8400-120-CCT-EM	B8400-150-CCT-EM
Rated voltage	220-240V~	
Frequency	50/60Hz	
Rated power	40W	55W
Lumen	5200lm	7150lm
Protection class	IP65	
Protection	IP65	
CCT	3000K/4000K/6500K	

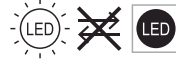
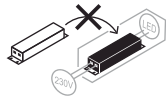

Safety tips

1. Use, 3x1.0mm² rubber cable.
2. Luminaire should be installed by authorized electrician only acc. to national wiring rules. If the external flexible cable or cord of this luminaire is damaged, it shall be exclusively replaced by the manufacturer or his service agent or similar qualified person in order to avoid a hazard.
3. The power supply must be deactivated prior to assembly, maintenance, exchanging the bulb or cleaning processes. Remove the fuse or switch the fuse to OFF and secure from reactivation.
4. picture 1, screw the gland.
5. Use a screwdriver to open the box.
6. Connect brown wire(L) to terminal L, blue wire (N) to terminal N, connect the grounding wire and green/yellow fixture wire .
7. terminal box installed back, the terminal box must be installed the correct position.

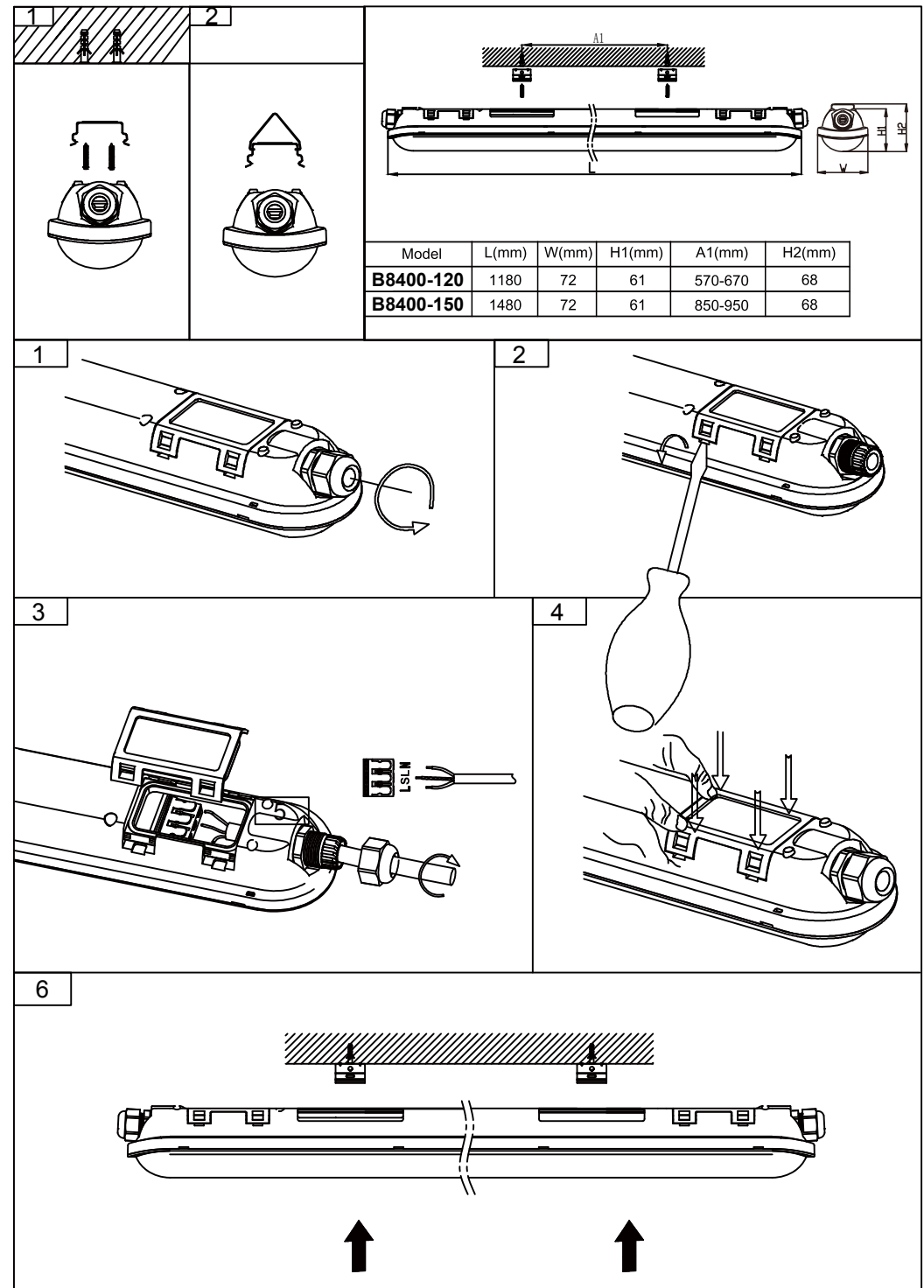

Isolated & Constant power LED Emergency converter

Applications:

Compliant 198-264Vac 50/60Hz input

Maintained emergency operation

PF(λ)>0.5

Electronic charge system

Green lighting Indicator

Constant power output

Deep discharge protection

Short-circuit-proof battery connection

Automatic shutdown for load out of range

Product protection class II

IP20 Protection level

Compatible all constant current LED driver

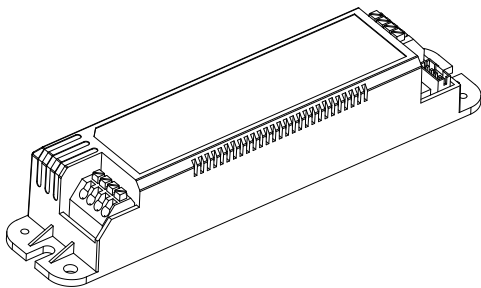

Type & Specific data

Type list	Charge current	Battery	Output parameter	Duration time
LYN4WH180P2	Max.300mA	LiFePO4 6.4V 3.0Ah	60-160Vdc 4W	180 minutes

Electrical input data

Specification item	Value	Unit	Condition
Rated supply voltage	220...240	Vac	
AC voltage range	198...264	Vac	Maximum permissible range
Max. input current	40	mA	Input voltage 220 Vac, full load
Power factor(λ)	> 0.5		Input voltage 230 Vac, full load
Max. input power	4	W	Input voltage 220 Vac, full load
Mains frequency	50...60	Hz	
Input inrush Current I-peak	3.86	A	240Vac input, 25℃, cold start
Input inrush Current T-width	102	us	240Vac input, measured at 50% Imax
Emergency states trigger	≤ 160	Vac	

Battery Charger data

Specification item	Value	Unit	Condition
Charging model	Constant Current		
Batteries SPEC	LiFePO4 IRF18650		3.2V/cell
Battery charging time	≥ 16	Hours	
Indicator light.1	Green on		Battery is charging
Indicator light.2	Green on		Battery is fully charged
Indicator light.3	Green off		The device is malfunction or no battery
Test switching	Hand movement		
Galvanic isolation	Isolated	SELV	Charge output to AC mains

Accessories

Indication green LED



Emergency data

Specification item	Value	Unit	Condition
Regulation method	Constant Power		
Starting delay time	< 1	second	From detection of emergency event
Deep discharge protection	5.0	Vdc	Battery output voltage
Stand LED driver input power	Max. 150	W	At 220-240Vac 50/60Hz
Stand LED driver out-current.1	≤ 2.0	A	LYN-L series Vout:20-60Vdc
Stand LED driver out-current.2	≤ 1.0	A	LYN-H series Vout:60-160Vdc
Galvanic isolation	Isolated		Emergency to AC mains and Charge output

Environment Requirements

Specification item	Value	Unit	Condition
Operating temperature	0...+50	℃	Matching Battery pack
Operating Relative Humidity	10...90	%	Non-condensing
Storage Temperature	-10...+70	℃	
Storage Relative Humidity	5...95	%	Non-condensing
Tcase-max	70	℃	Maximum temperature measured at Tc-point
Emergency Driver lifetime	30000	hours	At Tcase is ≤70℃
Battery lifetime	500	Cycle	Charge/discharge cycle

Non-maintained emergency operation-Wiring diagram

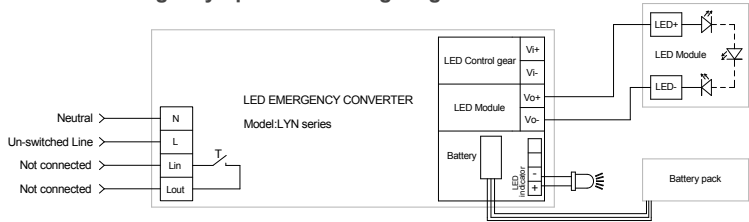

Maintained emergency operation-Wiring diagram

