

ST700CD-B

Microwave Sensor



Instruction

Welcome to use ST700CD-B Microwave Sensor!

The product is a new saving-energy product; it adopts microwave sensor mould with high-frequency electro-magnetic wave (5.8GHz) and integrated circuit. It gathers automatism, convenience, safety, saving-energy and practical functions. The wide detection field depends on detectors. It works by receiving human motion. When one enters the detection field, it can start the load at once and identify automatically day and night. Its installation is very convenient and its using is very wide. Detection is possible to go through doors, panes of glass or thin walls.

SPECIFICATION

Voltage	220-240V/AC	Detection Range	360°
Power Frequency	50/60Hz	Detection Distance	8m (radius), max
Time Delay	Min.10sec±3sec Max.12min±1min	Ambient Light	<3-2000LUX (adjustable)
Rated Load	Max.2000W ☀ 1000W ⚡	HF System	5.8GHz CW radar,ISM band
Detection Motion Speed	0.6-1.5m/s	Transmission Power	<0.2mW
		Installing Height	4-15m
		Power Consumption	approx 0.6W

FUNCTION

- Can identify day and night: It can work in the daytime and at night when it is adjusted on the “sun” position (max). It can work in the ambient light less than 3LUX when it is adjusted on the “3” position (min). As for the adjustment pattern, please refer to the testing pattern.
- SENS adjustable: It can be adjusted according to using location. The detection distance could be only 2m and high sensitivity could be 16m which fits for large room.
- Time-Delay is added continually: When it receives the second induction signals within the first induction, it will restart to time from the moment.
- Time-Delay is adjustable. It can be set according to the consumer’s desire. The minimum time is 10sec±3sec. The maximum is 12min±1min.

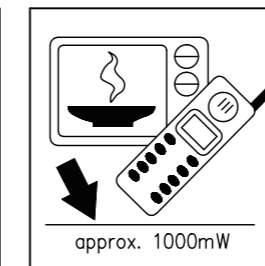
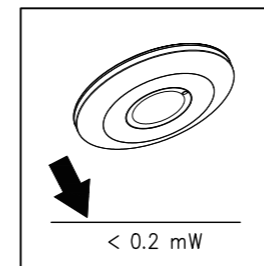

NOTE: the high-frequency output of the HF sensor is <0.2Mw- that is just one 5000th of the transmission power of a mobile phone or the output of a microwave oven, the baby can't touch it.

INSTALLATION (see the diagram)

- Please move the upper cover with anti-clockwise whirl as per the diagram on the right.
- Connect the power and the load according to the connection-wire diagram.
- Fix the bottom on the selected position with the inflated screw.
- Install back the upper cover on the sensor, then you could switch on the power and test it.

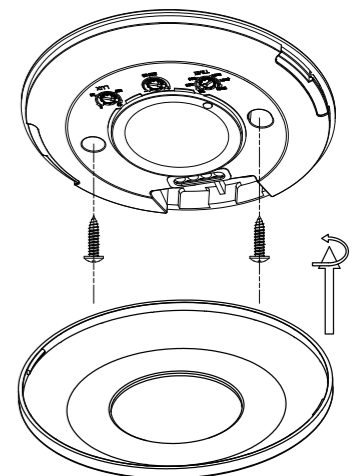

CONNECTION

⚠ WARNING Danger of death through electric shock!



- Must be installed by professional electrician.
- Disconnect power source.
- Cover or shield any adjacent live components.
- Ensure device cannot be switched on.
- Check power supply is disconnected.

CONNECTION-WIRE DIAGRAM

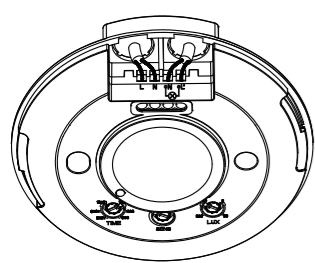

The wires come in and out from the bottom

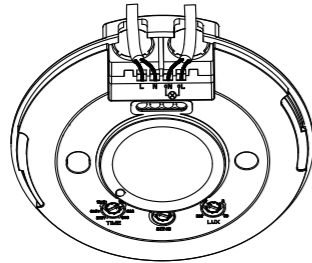

The wires come in and out from the side

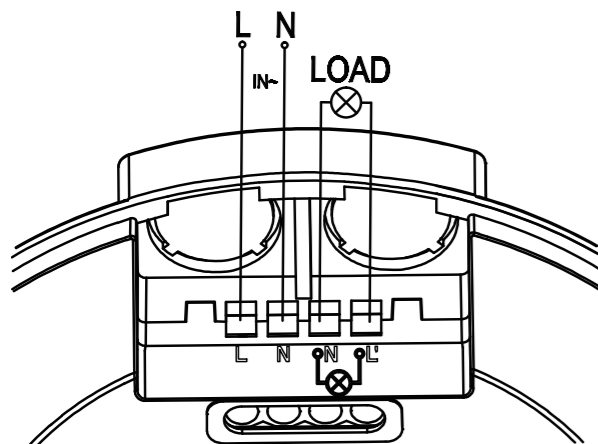

SENSOR INFORMATION

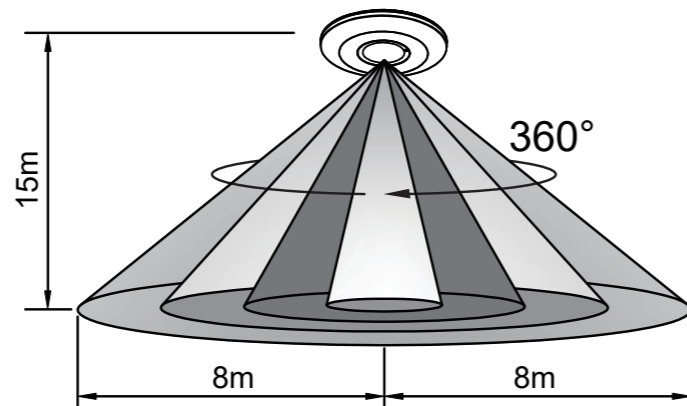

Height of installation: 4-15m

TEST

- Turn the TIME knob anti-clockwise on the minimum (10s). Turn the SENS knob clockwise on the maximum (+). Turn the LUX knob clockwise on the maximum (sun).
- When you switch on the power, the light will be on at once. And 10sec±3sec later the light will be off automatically. Then if the sensor receives induction signal again, it can work normally.

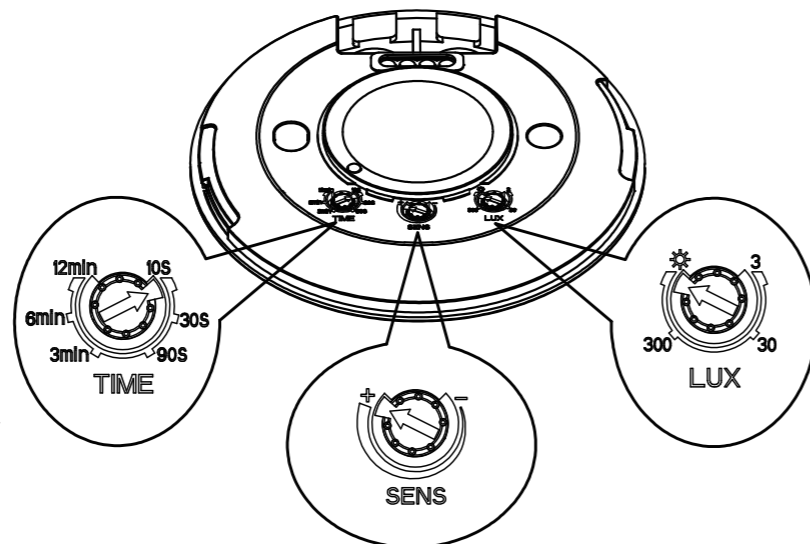

- When the sensor receives the second induction signals within the first induction, it will restart to time from the moment.
- Turn LUX knob anti-clockwise on the minimum (3). If the ambient light is less than 3LUX (darkness), the inductor load could work when it receives induction signal.

Note: when testing in daylight, please turn LUX knob to ☀ (SUN) position, otherwise the sensor lamp could not work!

NOTES

- Electrician or experienced human can install it.
- Can not be installed on the uneven and shaky surface
- In front of the sensor there shouldn't be obstructive object affecting detection.
- Avoid installing it near the metal and glass which may affect the sensor.
- For your safety, please don't open the case if you find hitch after installation.
- In order to avoid the unexpected damage of product, please add a safe device of current 6A when installing microwave sensor, for example, fuse, safe tube etc.

SOME PROBLEM AND SOLVED WAY

- **The load don't work:**
 - a. Check the power and the load.
 - b. Whether the indicator light is turned on after sensing? If yes, please check load.
 - c. If the indicator light is not on after sensing, please check if the working light corresponds to the ambient light.
 - d. Please check if the working voltage corresponds to the power source.
- **The sensitivity is poor:**
 - a. Please check if in front of the sensor there shouldn't be obstructive object that affect to receive the signals.
 - b. Please check if the signal source is in the detection fields.
 - c. Please check the installation height.
- **The sensor can't shut automatically the load:**
 - a. If there are continual signals in the detection fields.
 - b. If the time delay is set to the longest.
 - c. If the power corresponds to the instruction.