

SUSPENDED LIGHT SERIES

INSTALLATION INSTRUCTION

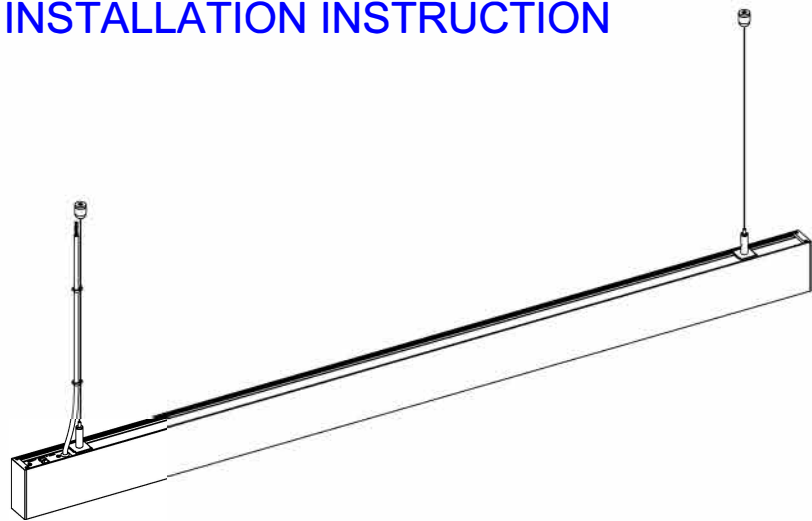

Install accessories

No.	Accessories	Picture	No.	Accessories	Picture
1	Plastic expansion pipe		6	Lock nut	
2	screw		7	Lock bolt	
3	Cylindrical bolt		8	Metal buckle	
4	Cylindrical nut		9	Wire rope buckle	
5	Seizing wire				

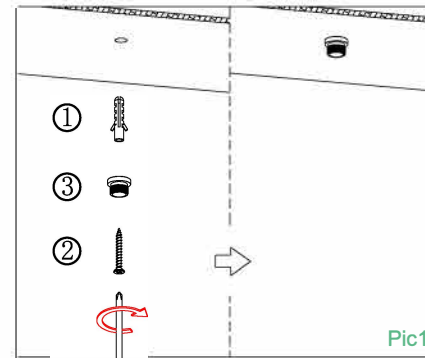

1. Insert ① into the pre drilled installation hole, and then lock ③ with ② onto ①.

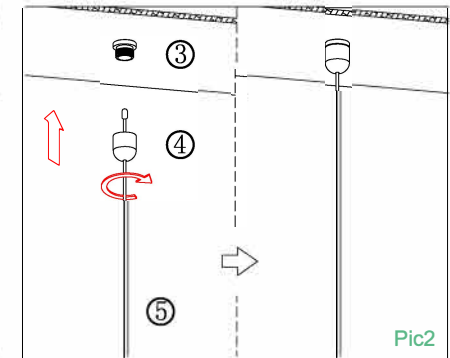

2. Thread ⑤ through ④ and lock ④ onto ③.

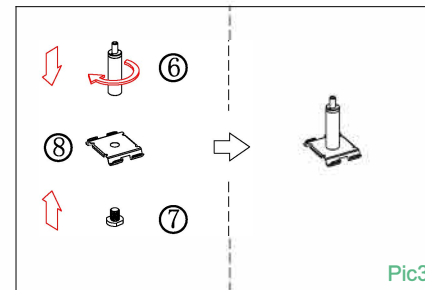

3. Thread ⑦ through ⑧ and lock it onto ⑥.

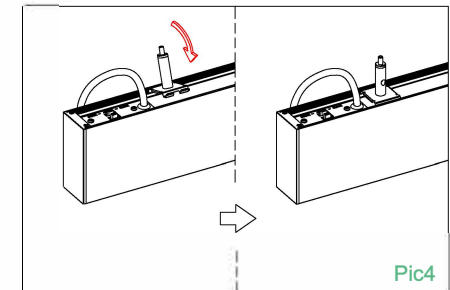

4. Insert the clip assembly into the lamp body as shown in the diagram.

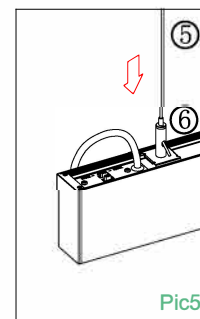

5. Thread ⑤ through ⑥, Adjust to the appropriate level Height.

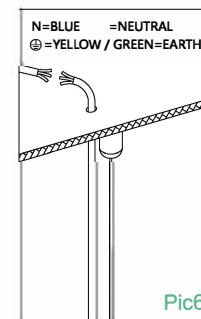

6. Connect according to the specifications power cord.

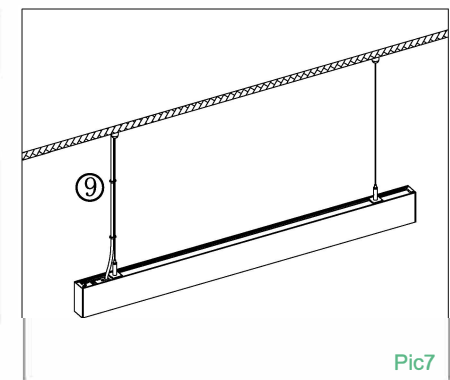

7. Connect ⑨ to the power line card and complete the installation.