

# Instruction Manual

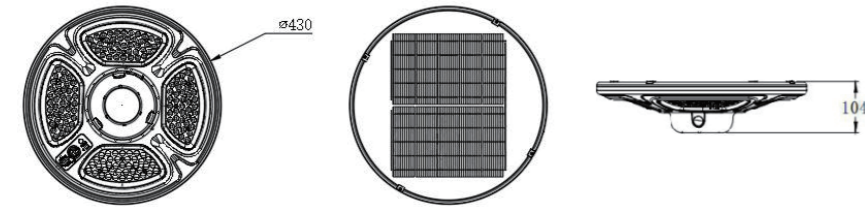

## Product parameter

|                          |  |
|--------------------------|--|
| Item                     | ZQ-TY02C-TJ150W  |
| LED chips                | SMD5050-164PCS   |
| Solar panel              | 15W  |
| Battery<br>LiFePO4       | 3.2V-15AH  |
| Max lumen(LM)            | 2000LM   |
| Lamp size (mm)           | Φ430*95mm  |
| Beam angle               | 90°  |
| Solar panel size(mm)     | Φ413*4mm   |
| Inner box size(mm)       | 475*71*568mm   |
| Induction mode           | PIR Sensor   |
| Installation height      | 2.5-5m   |
| Max induction            | 6-8m@Environment temperature25°C   |
| Induction angle          | 120°   |
| Light control            | 12-14H   |
| Working time             | Charge during the day (>10lux ) & light off, discharge at night (<5-10lux ) & light on |
| Charging time            | Normal illumination 4-6 hours (>40000lux)  |
| Number of cycles         | >1200  |
| Material & color         | ABS, black   |
| IP rating                | IP54   |
| Temperature and Humidity | Temperature: charging above 10°C, discharging above -5°C<br>Working humidity: 95%RH    |

### Kindly reminder:

- After the remote control turns off the lamp for more than 48 hours, the lamp body enters the sleep mode, the standby current is 5uA.The lamp must be connected to the solar panel when it works again.
- Please keep the remote control, and do not lose it.
- The time control key has memory functions. After a charging cycle,the lamp will automatically enter the time control mode of last time without pressing any key.

## Remote Function



| Key    | Function   | Period of validity      | Valid Period | Function Description   |
|--------|--|-------------------------|--------------|--|
| 【ON】   | Light ON   | Single time             | Day & Night  | 100% brightness - gradually decrease, turn off the lamp after approximately 12 to 14 hours.  |
|        | Enable to light on   | Single time             | Day & Night  | When the light is not ON, simply press the 【ON】 key to turn it off.  |
| 【OFF】  | Light OFF  | Single time             | Day & Night  | Light OFF.   |
|        | Power off  | Every day (with memory) | Day & Night  | Long press the "OFF" key for 3S, the lamp will be light off and still can be charged, but can't light on until press the "ON" key.   |
| •••    | PIR Induction mode   | Every day (with memory) | Night        | 1. Low brightness when nobody within sensing range.<br>2. 165% brightness once PIR sensor detects people in sensing range.   |
| 4H+••• | Timing control for 4 hours, then enter to PIR Induction mode | Every day (with memory) | Night        | Light on 100% brightness and gradually decrease for 4 hours, then enter PIR induction mode.Low brightness when nobody within sensing range, 100% brightness once PIR sensor detects people in sensing range. |
| 【3H】   | Timing control 3 hours.                                      | Every day (with memory) | Night        | Keep on 100% brightness, light OFF after 3 hours.  |
| 【6H】   | Timing control 6 hours.                                      | Every day (with memory) | Night        | Light on 100% brightness then gradually decrease, light off after 6 hours.   |
| 【12H】  | Timing control 12 hours.                                     | Every day (with memory) | Night        | Light on 100% brightness then gradually decrease, light off after 12 hours.  |
| 【AUTO】 | Time control 14 hours  | Every day (with memory) | Night        | Light on 100% brightness then gradually decrease, light off after 14 hours.  |

## Installation Instructions

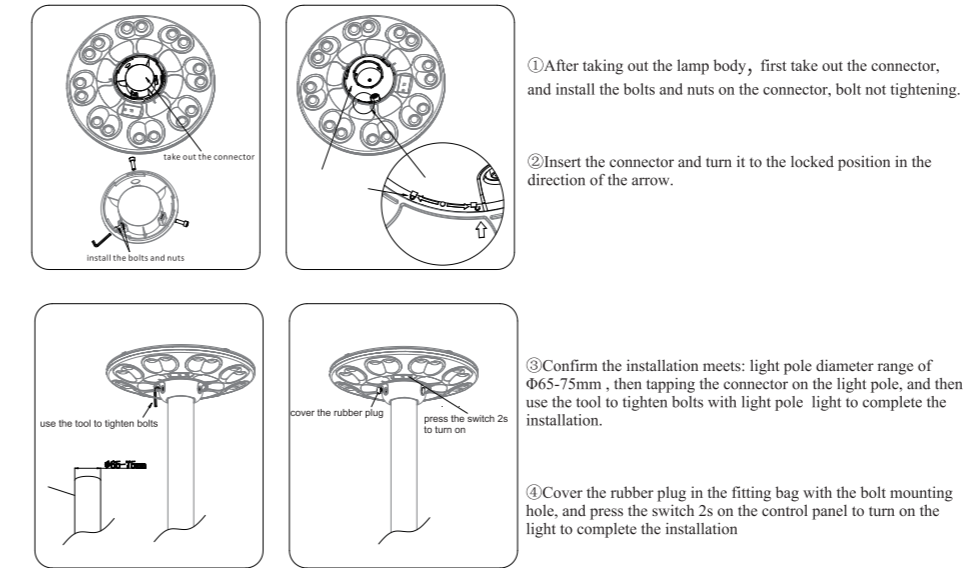

## Tank and Base

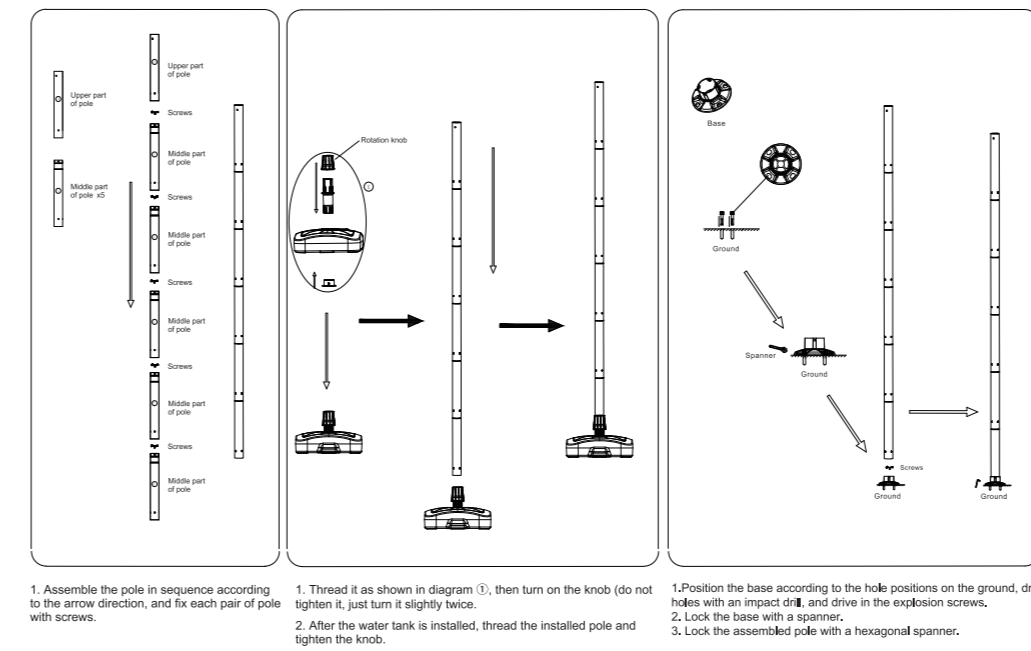

## Installation of Tank

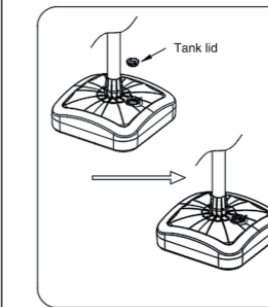

- Open the tank lid, fill with water or sand.

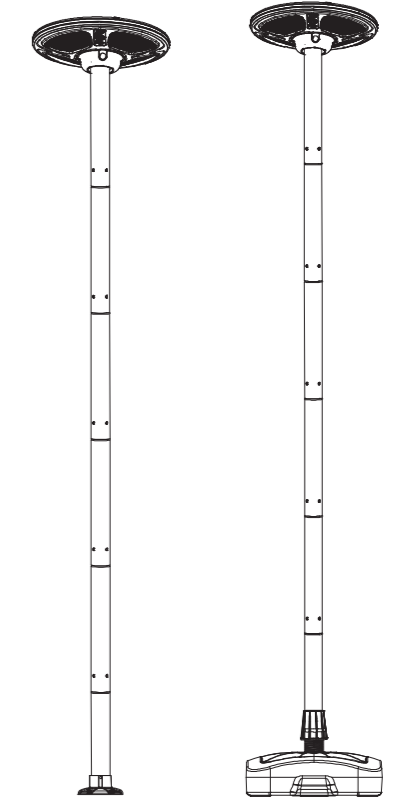

Final installation picture for reference

## Important Notice

- ★ Please keep the installation tools away from children.
- ★ Contains batteries, batteries are recyclable, please do not throw them away.
- ★ Contains batteries, the product is strictly prohibited to be placed on fire, it may explode.
- ★ Please do not connect to 110/220V alternating current to avoid damage to the lamp body.
- ★ Please install on a flat and stable surface, and fix the photovoltaic panel and the lamp body to prevent wind or other reasons from hurting people.
- ★ In order not to affect the use effect, clean up the dust or debris on the surface of the solar photovoltaic panel every 3-4 months.
- ★ In autumn, winter, continuous cloudy or rainy days, the charging effect will be weakened and the lighting time will be shortened, which is normal.
- ★ Avoid installing lamps near air conditioners, heating objects, or high-voltage power grid systems.